

202HD - HD Mounted Series



The popular long steel barrel **202HD** is a compact powerful fixture mount motor with governed constant speed ranges of 30,000, 40,000, 50,000 and 65,000 rpm. Drill rubber, plastic or mill faster and cleaner. Collet capacities of ER 8 1/8" (3mm) with optional collets for smaller and metric applications available.

The **202HD** has the advantage of a stainless steel barrel for rigid fixture mounting in applications such as plastic drilling and robotic metal finishing.

Oil free operation eliminates part contamination.

Dimensions

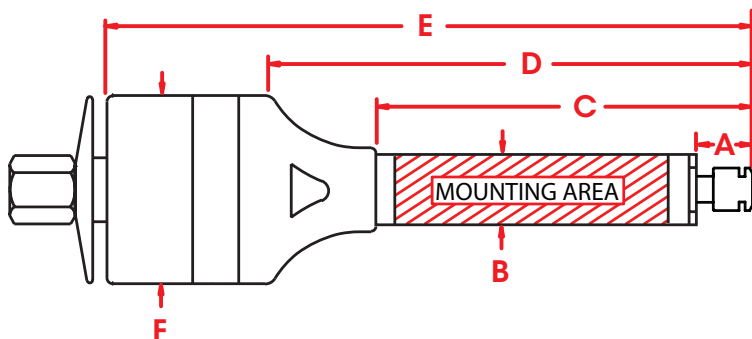

A	1.33" (33.84mm)	C	4.27" (108.33mm)	E	7.13" (181.10mm)
B	0.74" (18.84mm)	D	5.35" (135.95mm)	F	2.00" (50.85mm)

202HD Series

ER8 - 1/8"		ER8 - 3mm	
Speed RPM	Part #	Speed RPM	Part #
30,000	32800	30,000	32801
40,000	32802	40,000	32803
50,000	32804	50,000	32805
65,000	32806	65,000	32807

Accessories

Model	Part #
High Flow Filter	30004
High Flow Filter / Regulator	30003
5' Air Supply Assembly w/Fitting	30010

General Specifications

202HD

Speed RPM	30,000 / 40,000 / 50,000 / 65,000
Power Rating hp (kW)	0.4 (.30) / 0.45 (.34) / 0.5 (.37) / 0.55 (.41)
Inlet Air Pressure	90 psi (6.2 bar)
Air Consumption Idle cfm (l/s)	10 (4.7) / 13 (6.1) / 14 (6.6) / 14 (6.6)
Air Consumption Working Flow cfm (l/s)	11 (5.19) - 20 (9.4)
Sound Level	Less Than 78 dBA
Max Shank Capacity	ER 8 - 1/8" (3mm)
Motor Weight	9 oz (0.26 kg)

Standard Equipment

Motor, ER 8 collet system (1/8" or 3mm collet standard - other sizes optional), collet wrenches, rear exhaust, and 1/4" NPT air supply fitting.

Oil free 90 psi (6.2 bar), clean, dry air supply required

Ceramic bearing option available.

Tel: +1.561.994.0500 • Fax: +1.561.994.8097 • www.airturbinetools.com • info@airturbinetools.com

Use couplings / hoses with a minimum ID of 5mm for 720, 722, 730 and 732 motors, a minimum ID of 1/4" / 6mm for 202 motors, a minimum ID of 6.5mm for 725MX and 740MX motors, a minimum ID of 8mm for 450, 460 and 740XP motors, a minimum ID of 3/8" / 9.5mm for 210 motors and a minimum ID of 10mm for 450X and 460X motors. Always use a 0.3 micron filter and/or extractor where required and check specified psi or l/s air flow. Use 90 psi / 6.2 Bar clean, dry, oil-free air only. Use eye protection and follow safety instructions. Supply is subject to Air Turbine Tools Inc. terms and conditions of sale and distributor policies in effect for the time being. Subject to availability, change of specifications, price and terms without notice. All specifications approximate. Air Turbine Motors® is the registered trade name of Air Turbine Tools, Inc. © 2017 Air Turbine Tools, Inc. All rights reserved.