

From deburring to finishing, the **2545SVR** increases production rates and reduces repairs, fatigue and injury. With no gears the **2545SVR** tools have a head angled at 45° for comfort and easy access. The **2545SVR** can perform tasks requiring slower speeds and increased power, such as grinding, deburring and polishing. Standard collet capacities of 1/4" and 6 mm, with several optional collets for smaller and metric applications. These tools are gearless and have no moving parts in the handle. Result - a lighter tool with greater reliability! The **2545SVR** has a rear exhaust to help keep the work area clear of debris.

**Model 2545SVR**

0.45 hp  
0.34 kW

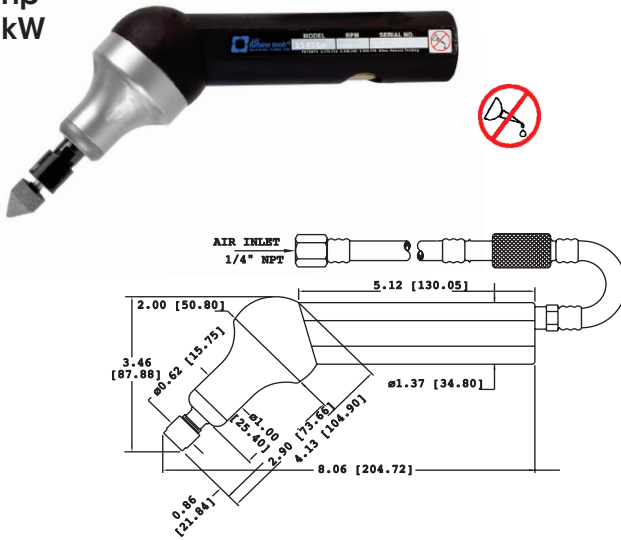



1/4"	No Brake	With Brake
Speed	Part #	Part #
30,000 rpm	35530	35630
40,000 rpm	35540	35640

6mm	No Brake	With Brake
Speed	Part #	Part #
30,000 rpm	35531	35631
40,000 rpm	35541	35641

**Weight: 18oz / 0.5kg**

**Standard Equipment Included:** 1/4" or optional 6mm collet, collet wrenches, 5' air supply assembly with slide valve and 1/4" NPT air supply fitting. Oil free 90 psi / 6.2 bar dry, clean air supply required.  
**Optional collets page 49.**

General Specifications	 2545SVR 	
Speed RPM	30,000	40,000
Power Rating HP (KW)	.4 (30)	.45 (.34)
Inlet Air Pressure	90 PSI (6.2 Bar)	
Air Consumption - Idle cfm (L/s)	10 (4.72)	13 (6.14)
Air Consumption - Working cfm (L/s)	11 (5.19) - 20 (9.44)	
TR Collet Held Shank	Less than .001" (.03mm)	
Sound Level	Less than 67dBa	
Standard Shank Capacity	1/4" (6mm)	

**Accessories**

	Part#
High Flow Filter	30004
High Flow Filter / Regulator	30003
Foot Pedal Control	30030
5' Air Supply Assy w/Fitting	34207

