

Patented Double Turbine extra power unite for unmatched high speed at 40,000RPM generating 1.40hp in this powerful tool with the reach for deep pockets, robotic face or edge milling, or furnishing operations. Constant high speed results in superior endmill performance and life. Dual ceramic bearings and low friction direct drive bearings result in maintenance free low vibration cutting with tools up to 1/4" / 6mm capacity. Specify angular bearings for drilling.

**Model 650XJSL**

**1.4 hp**  
**1.04 kW**

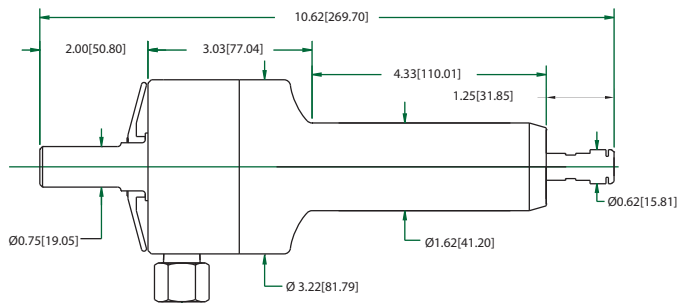

General Specifications	650XJSL		
	CE	MADE IN THE USA	
Speed RPM	25,000	30,000	40,000
Power Rating HP (KW)	1.2 (.90)	1.3 (.98)	1.4 (1.04)
Inlet Air Pressure	90 PSI (6.2 Bar)		
Air Consumption-Idle cfm (L/s)	16 (7.56)	17 (8.02)	18 (8.49)
Air Consumption-Working cfm (L/s)	19 (8.97) - 30 (14.16)		
TIR Collet Held Shank	Less Than 0.0002" (0.005mm)		
Sound Level	Less than 67 dBa		
Standard Shank Capacity	1/4" (6mm)		

1/4"		6mm	
Speed	Part #	Speed	Part #
25,000 rpm	63118	25,000 rpm	63119
30,000 rpm	63120	30,000 rpm	63121
40,000 rpm	63122	40,000 rpm	63123

**Weight: 96oz / 2.72kg**

**Standard Equipment:** Spindle, combo filter extractor, collet, wrenches, plug (for alternate air inlet not in use) and carrying case.

ER11 collet system standard (1/4" or 6mm collet standard - other sizes optional). 3/4" or 20mm straight shank option standard, Oil free 90PSI / 6.2BAR, clean, dry air supply.

**Accessories**

High Flow Filter /Regulator/Extractor **Part# 30008**

**Hose & Fitting Assemblies**

Tube 12mm O.D. - 8mm I.D. **Part# 16509**  
(order by the foot)

Hose & Fitting - 6' **30044**

Hose & Fitting - 12' **30045**