

With Air Turbine Spindles™ patented double turbine's extra power the 1.4HP / 1.04 kW maintaining stable high speed and torque under load. The 650XJS accelerates feed rates and cuts cycle times. Rated governed speeds available are 25,000 , 30,000 and 40,000 rpm. Super precision at 0.0002" / 0.00508mm. with H6 Shank Tolerance. In 24 hour operation the patented governed high speed 650XJS delivers constant high speed and torque under load with high reliability and accuracy as a result of its low friction power unit with few moving parts. Plenty of power to speed up your inches cut per minute. High cutting speeds are maintained at the periphery of your end mill or bur using the the 650X's unique governed performance to achieve a faster cycle time, a cleaner finished surface and more production on your CNC. Longer endmill life results from faster cutting with a light pass and no gears, vanes or brushes to burn up.

## Model 650XJS

**1.4 hp**  
**1.04 kW**

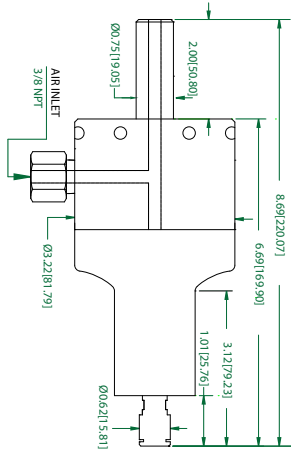

1/4"		6mm	
Speed	Part #	Speed	Part #
25,000 rpm	63040	25,000 rpm	63041
30,000 rpm	63042	30,000 rpm	63043
40,000 rpm	63044	40,000 rpm	63045

**Weight: 75.2oz / 2.13kg**

**Standard Equipment:** Spindle, combo filter extractor, collet, wrenches, plug (for alternate air inlet not in use) and carrying case.

ER11 collet system standard (1/4" or 6mm collet standard - other sizes optional). 3/4" or 20mm straight shank option standard, Oil free 90PSI / 6.2BAR, clean, dry air supply.

General Specifications	650XJS		
	CE	USA	USA
Speed RPM	25,000	30,000	40,000
Power Rating HP (KW)	1.2 (.90)	1.3 (.98)	1.4 (1.04)
Inlet Air Pressure	90 PSI (6.2 Bar)		
Air Consumption-Idle cfm (L/s)	16 (7.56)	17 (8.02)	18 (8.49)
Air Consumption-Working cfm (L/s)	19 (8.97) - 30 (14.16)		
TIR Collet Held Shank	Less Than 0.0002" (0.005mm)		
Sound Level	Less than 67 dBa		
Standard Shank Capacity	1/4" (6mm)		

### Accessories

High Flow Filter /Regulator/Extractor

**Part#**

30008

### Hose & Fitting Assemblies

Tube 12mm O.D. - 8mm I.D.  
(order by the foot)

**Part#**

16509

Hose & Fitting - 6'

30044

Hose & Fitting - 12'

30045